

DAILY RATE SCHEDULE

Check-In After 3:00 pm - Check Out 10:00 am

Arrivals after 6pm must notify office.

Rates apply to ADVANCE RESERVATIONS with confirmed deposit ONLY. Last years' rates do not apply to current years' rates. RATES DO NOT APPLY TO HOLIDAYS, CONVENTIONS OR WEEKENDS. To Guarantee rates quoted on rate brochure deposit must be received by June 1st. \$25 Fee to guarantee room number and floor location. All Specials and rates + 14% tax. Sorry no pets.

ROOM LAYOUTS

Efficiencies on the 1st, 2nd & 4th Floors.
2 Room Suites are on the 3rd Floor.

(A) Two Room Suite

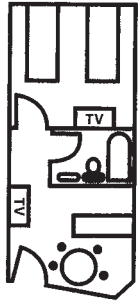

(B) Two Room Efficiency

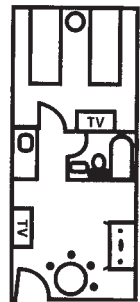

(C) Three Room Efficiency

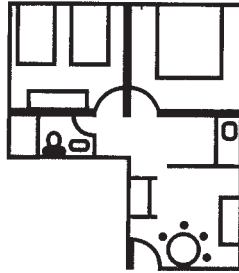

(D) Pent House 4 Room Efficiency

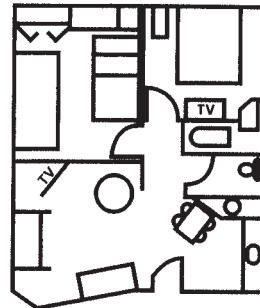

2017 SPECIALS

SPECIAL E

Labor Day
September 1-4
4 Days/3 Nights

Motel Room or Two Room Suite \$369 Plus Tax
Two Room Efficiency \$405 Plus Tax
4 Person

SPECIAL F

Roar to the Shore
September 8-10
3 Days/2 Nights

\$175 Plus Tax
2 Persons

SPECIAL G

Fall Classic Car Show & Auction
September 21-24
4 days/ 3 Nights

Motel Room or Two Room Suite \$255 Plus Tax
Two Room Efficiency \$290 Plus Tax
2 Persons

- 1 Car Per Unit (Strictly Enforced)
- Pay in cash and get 2% off your total before tax.
- If you care to use a credit card there is a handling charge on the balance due.

PLEASE NOTE: Special Rates apply to advance reservations only. Rates do not include 7% local tourism tax or 7% sales tax. 3 Night minimum reservation on weekends. Please make note we do not assign room numbers until the day you arrive. Deposits secured by credit cards are not refundable. NO early check-ins please! Check out time applies to Auto's as well as rooms. Deposit is refundable if notified 2 weeks in advance with service charge of 25%. If canceled less than 2 weeks in advance, your deposit is not refundable. **NO REFUNDS ON EARLY DEPARTURES OR DUE TO ADVERSE WEATHER CONDITIONS. ARRIVALS AFTER 6 PM ARE REQUIRED TO CALL TO HOLD RESERVATION.**

Many thanks for your trust and confidence. Our business has grown by referrals and customers who were pleased with our accommodations.

CHECK IN - CHECK OUT	MOTEL ROOM OR TWO ROOM SUITE (A)	TWO ROOM EFFICIENCY SUITE (B)	THREE ROOM SUITE 2 BATHS 2 BEDROOMS	THREE ROOM EFFICIENCY 2 BATHS 2 BEDROOMS (C)	4TH FLOOR PENTHOUSE 2 BATHS, 2 BEDROOMS, LIVING RM, KITCHEN, (D)	EXTRA PERSON IN ROOM	NUMBER OF PERSONS
May 1 - May 26	\$75	\$80	\$90	\$99	\$150	\$5	2
May 26 - May 29	\$130	\$145	\$179	\$200	\$225	\$10	4
May 29 - June 11	\$90	\$105	\$130	\$170	\$195	\$10	2
June 11 - June 30	\$110	\$120	\$140	\$180	\$210	\$10	4
June 30 - July 14	\$145	\$155	\$189	\$250	\$285	\$10	4
July 14 - August 13	\$165	\$179	\$250	\$295	\$325	\$10	4
August 13 - September 4	\$130	\$145	\$169	\$200	\$225	\$10	4
September 4 - September 14	\$85	\$90	\$110	\$125	\$215	\$10	2
September 14 - September 17	\$144	\$148	\$169	\$200	\$225	\$10	4
September 17 - September 21	\$85	\$90	\$110	\$125	\$215	\$10	2
September 21 - September 24	\$95	\$109	\$165	\$194	\$205	\$10	2
September 24 - October 1	\$75	\$85	\$125	\$135	\$175	\$5	2
FAMILY RATES SPECIAL - Requires \$250 Deposit - Rates do not include 7% Sales and 7% Tourism Tax. Limited rooms available.							
6 DAYS/ 5 NIGHTS							
May 7 - 12							
May 14 - 19	\$275	\$300	\$350	\$395	\$650	\$5	2
May 21 - 26							
June 4 - 9	\$375	\$450	\$575	\$775	\$900	\$5	4
June 11 - 16	\$495	\$525	\$625	\$825	\$975	\$10	4
June 18 - 23	\$495	\$545	\$645	\$845	\$995	\$10	4
July 4 - 9	\$590	\$605	\$775	\$800	\$1110	\$10	4
July 9 - 14	\$565	\$650	\$885	\$945	\$1200	\$10	4
July 16 - 21	\$800	\$875	\$1025	\$1125	\$1425	\$10	4
8 DAYS / 7 NIGHTS							
July 9 - 16	\$770	\$840	\$910	\$1000	\$1090	\$10	4
July 16 - 23	\$985	\$1020	\$1225	\$1400	\$2095	\$10	4
5 DAYS / 4 NIGHTS							
September 4 - 8	\$250	\$275	\$350	\$400	\$595	\$10	2
September 10 - 14	\$300	\$320	\$400	\$460	\$820	\$10	4
September 17 - 21	\$280	\$300	\$380	\$440	\$800	\$10	4
September 24 - 28	\$240	\$280	\$420	\$460	\$600	\$5	2

2017 SPECIALS

• SPECIAL A

Spring Weekend - Car Show

May 12-14

3 Days/2 Nights

\$120 Per Night (Plus tax)

2 Persons, Sunday Late Checkout!



• SPECIAL B

"Who Killed Peggy Sue at the Hop" Weekend

May 19-21

3 Days/2 Nights

Motel Room or Two Room Suite \$408 Plus Tax

Two Room Efficiency \$428 Plus Tax

2 Persons

Weekend Includes:

- **Ticket to Welcome Party & Old Fashioned Drive In Movie** - Bring a beach blanket or chair and enjoy a night under the stars watching a fun 1950's era movie.
- **Breakfast Ticket** - Complete Breakfast at a choice of selected restaurants.
- **Dinner Ticket** - 3 Course Dinner at choice of selected restaurants featuring a special menu for the weekend.
- **Murder Mystery Show & Sock Hop Ticket** - Not only do you need to solve the Murder, you are also participating in the events leading up to it. Don't forget to dress the part!
- **The Case File for Scavenger Hunt** - All the clues for a 2nd mystery are found at local retail stores listed in Case File. Prizes will be awarded at the Murder Mystery Show & Sock Hop.



• SPECIAL C

Memorial Weekend

May 26 - 29

4 days/3 Nights

Motel room or Two Room Suite \$335 Plus Tax

Two Room Efficiency \$365 Plus Tax

4 Persons

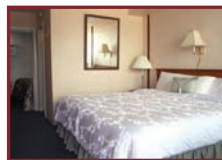

• SPECIAL D

Independence Day

June 30 - July 4

5 Days/4 Nights

Motel Room or Two Room Suite \$545 Plus Tax

Two-Room Efficiency \$581 Plus Tax

4 Persons

AMENITIES

Cleanliness is our priority

- All Rooms Updated
- Ocean-view sun deck with Southern Exposure
- Heated Swimming Pool/ Kiddie Pool
- Daily Maid Service
- Air Conditioning and Heat
- Flat Screen TV's
- Free Wireless WiFi
- No Beach Fees
- Guest Coin Laundromat
- Ice & Beverage Machines
- Mini Golf, Ping Pong, Pool Table
- Elevator
- Barbecue Grill
- Free Parking; One car per unit
- All rooms are Non-Smoking. Please smoke outside
- Just steps away: Tennis & Basketball Courts, Bike Rentals, Bike Path, Library, Gazebo w/ Music
- In Room Phone
- Hair Dryer in All Rooms
- A.M. coffee in Lobby
- ATM in Lobby
- Ceiling Fans in all Front Rooms
- Refrigerator
- Microwave Oven
- Coffee Maker
- All Efficiency Rooms are equipped with stove tops, pots, pans, dishes & silverware

The Entrance to the Wildwood's Famous Boardwalk is just a few blocks away!

BOOK ANY ONE OF OUR FAMILY RATE SPECIALS AND RECEIVE A 10% DISCOUNT OFF BEFORE TAXES. DEPOSIT OF \$250 MUST BE RECEIVED BY JANUARY 31, 2017. (No Exceptions)

POLICIES: RATES ARE SUBJECT TO CHANGE WITHOUT NOTICE. Terms: All rates are discounted cash rates. A deposit of 2 days rental is required to confirm reservations. Deposit credited to first and last day of period reserve. Personal checks on deposit only. Balance due on arrival in cash or traveler's checks (no personal checks). No refund or credit on unused days or no shows - no exceptions. Neither unused days nor deposits are transferable to another guest or time period. All Specials and rates + 14% tax. Sorry no pets.

PLEASE NOTE: All reservations are subject to confirmation and to strikes, failure of guests to vacate, causes or conditions beyond our control. We are not affiliated with any other motel. This property is privately owned and the management reserves the right to refuse service to anyone. Misrepresentation Voids Reservation. Rates subject to change unless secured by advance deposit and reservation.

As a matter of public health children who are not fully potty trained must wear a "swim diaper" in pool.

Cape Cod Inn
6109 Atlantic Avenue
Wildwood Crest, New Jersey 08260



**FAMILY ORIENTED
JUST STEPS FROM THE BEACH**



"A Touch of Old New England on the Jersey Shore"



**Motel is located on Ocean Avenue,
Sweetbriar Road and Atlantic Avenue**

**6109 Atlantic Avenue
Wildwood Crest, New Jersey 08260**

(609) 522-1177

www.capecodinnmotel@yahoo.com

www.capecodinnmotel.com